

# FleetCam Pro Installation Guide

Version 1.0i



# Table of contents

Safety instructions & pre/post-installation checklist .....	3
In the box .....	4
OBD-II Installation.....	5
Installation Diagram.....	6
Dash Cam mounting.....	7
Power box installation .....	8
V-Display installation (optional) .....	9
OBD-II connection .....	10
JBUS installation.....	11
Installation diagram.....	12
Dash Cam mounting.....	13
JBUS power connection .....	14
Hardwired installation .....	15
Installation diagram.....	16
Recommended tools & supplies.....	17
Approved hardwired termination methods .....	18
Prohibited hardwired termination methods .....	19
FleetCam Pro with FCP Hub.....	20
FCP Hub OBD-II installation diagram .....	21
FCP Hub JBUS installation diagram.....	22
FCP Hub hardwire installation.....	23
FC Pro LCD Screen Installation.....	24
LED indicators diagram .....	25

# Safety instructions & pre/post-installation checklist

## Safety & Preparation:

- Have vehicle parked in a location away from any moving traffic
- Allow yourself to have enough space where you can fully open the vehicles doors and work safely
- Make sure the installation location has adequate lighting
- Fuse any wires that carry electrical current
- Protect any wires/cables that exit the vehicle with grommet(s) & split loom

## Perform pre/post vehicle inspection.

Please inspect functionality of items listed below before and after installation:

- Headlights/Taillights
- Front/Rear blinkers.
- Hazards
- Dash warning lights (Ex: Check engine light, ABS light, Air bag light)
- Vehicle body (Note any obvious damage of exterior body panels)
- Interior (Note if dashboard or interior panels are damaged or cracked, also if any screws or clips are missing)
- Vehicle: Start/Stop
- Radio
- Electric seats
- Windows
- Windshield
- Interior lights

## Installation Disclaimer

Installation should be performed by a qualified professional only.

If any installation help is needed, please reach out to FTS Support Desk for assistance: 866-221-1862 ext. 2/ support@ftsgps.com

# In the box



FleetCam Pro

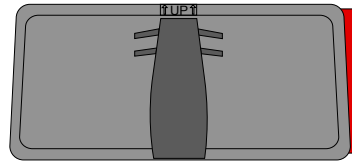

Mounting bracket

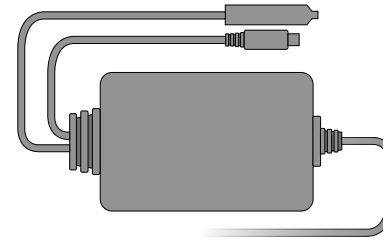

Power Box Harness

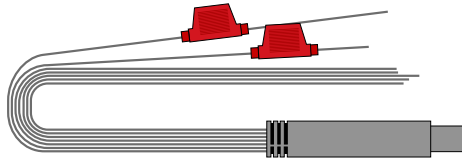

Hardwire Harness

## Optional cables (Not included)

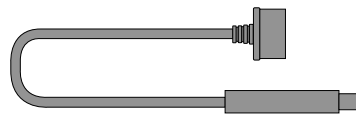

OBD-II Harness



JBUS Harness

# OBD-II Installation

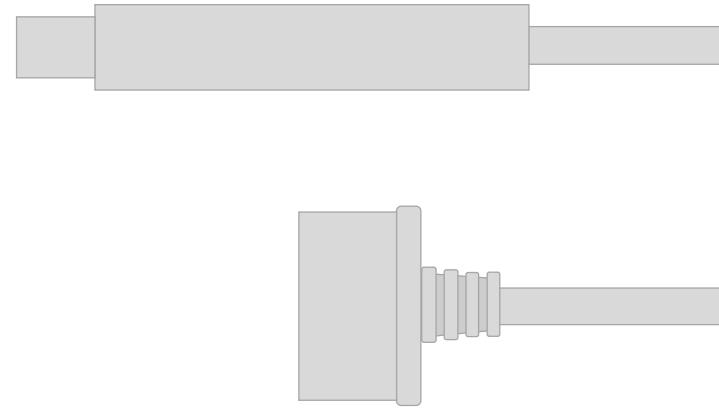

# OBD-II installation diagram

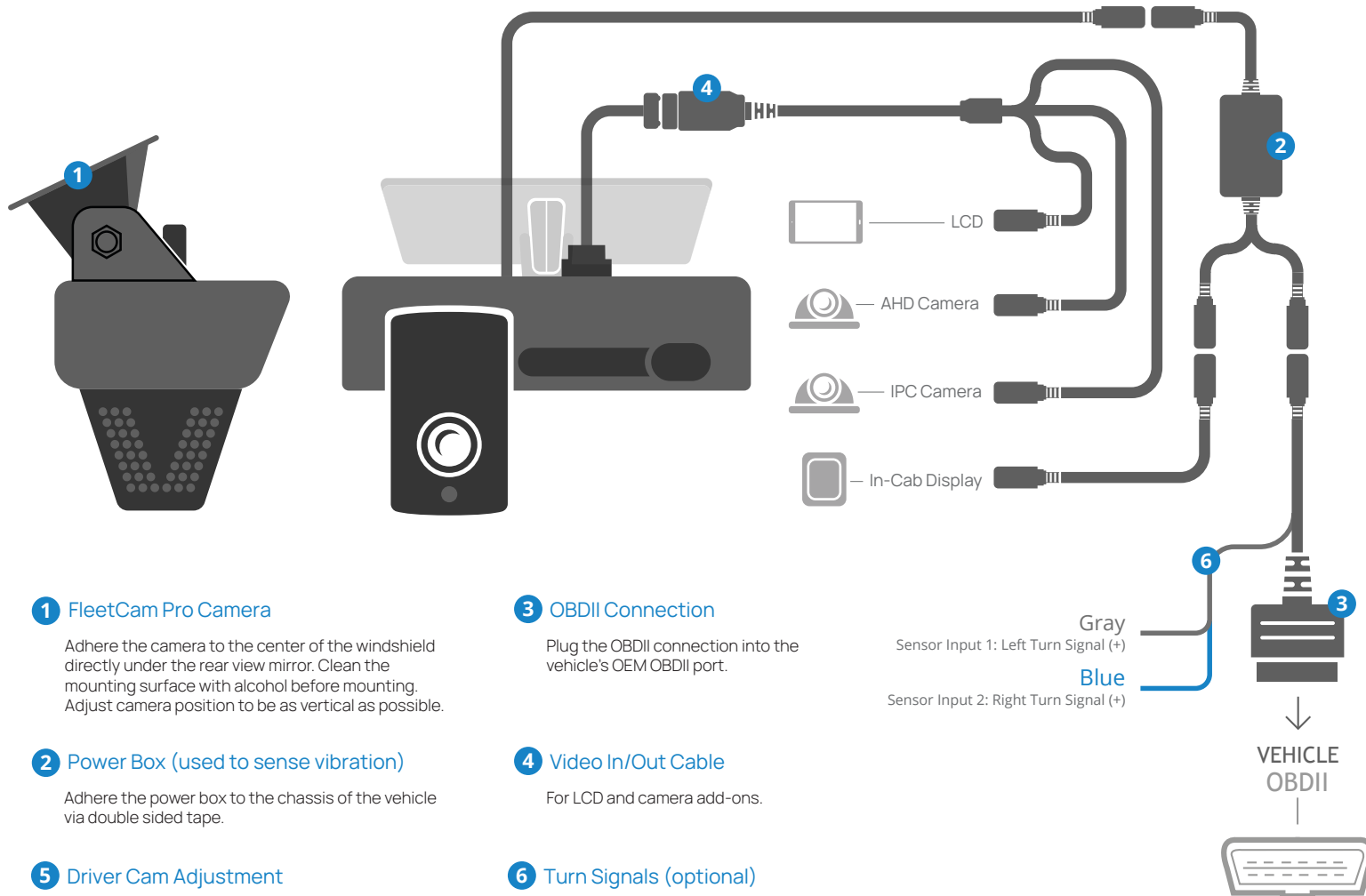

## 1 FleetCam Pro Camera

Adhere the camera to the center of the windshield directly under the rear view mirror. Clean the mounting surface with alcohol before mounting. Adjust camera position to be as vertical as possible.

## 2 Power Box (used to sense vibration)

Adhere the power box to the chassis of the vehicle via double sided tape.

## 5 Driver Cam Adjustment

Adjust the driver cam lens so that the driver's face is just above the center line of the live stream view.

## 3 OBDII Connection

Plug the OBDII connection into the vehicle's OEM OBDII port.

## 4 Video In/Out Cable

For LCD and camera add-ons.

## 6 Turn Signals (optional)

Connect the gray wire (sensor input 1) to left turn signal (+).  
Connect the blue wire (sensor input 2) to right turn signal (+).

# Dash Cam mounting (OBD-II)

- Desired installation location is in the center of the windshield directly under the rear-view mirror (see figure 1 for reference).
- If the center of the windshield is an obstruction to the driver's line of vision the FC Pro can be offset towards the passenger side of the windshield (see figure 2 for reference). **Maximum offset measurement allowed is 4 inches (10.16cm).**
- If camera is not installed in the center of the windshield, the offset measurements must be entered during the calibration process (see FleetCam Pro Titan User Guide).
- Clean the mounting surface with rubbing alcohol before adhering the mounting bracket to windshield.
- Adhere mounting bracket by pressing bracket firmly on the windshield (Up indication on mounting bracket must point towards the ceiling).
- Secure the FleetCam Pro Camera to the mounting bracket w/ provided Phillips screw.
- Adjust camera position to be as vertical as possible.

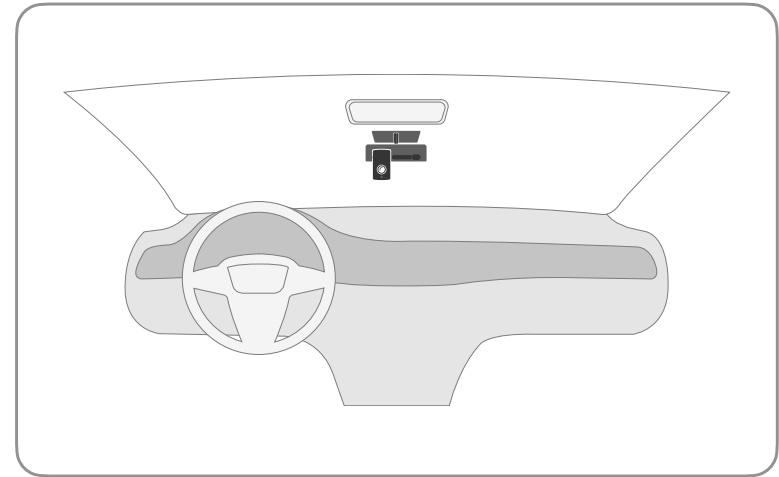

Fig. 1 Center Mount  
(recommended)

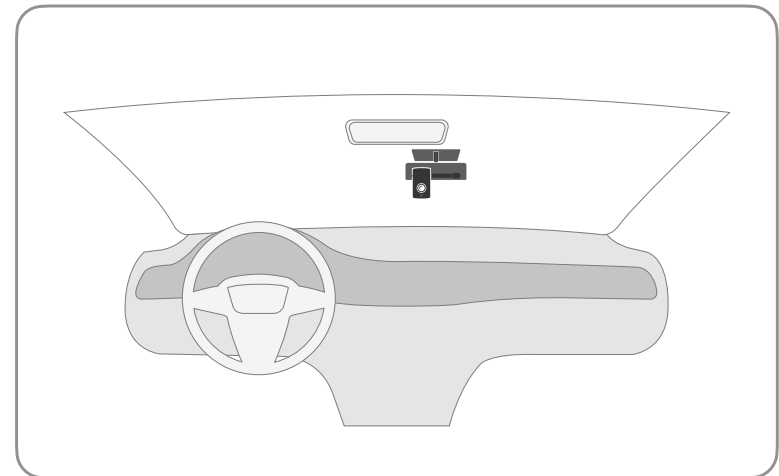

Fig. 2 Offset mount  
(Should be no more than 4 inches.)

# Power box installation

Adhere the power box to the chassis of the vehicle (underneath steering column area) via double sided tape.

For added security a zip-tie can also be used to secure the power box.





## V-Display installation (optional)

Adhere V-Display to the top of the dashboard in a location easily viewable by the driver.

Clean surface with rubbing alcohol before adhering V-Display.

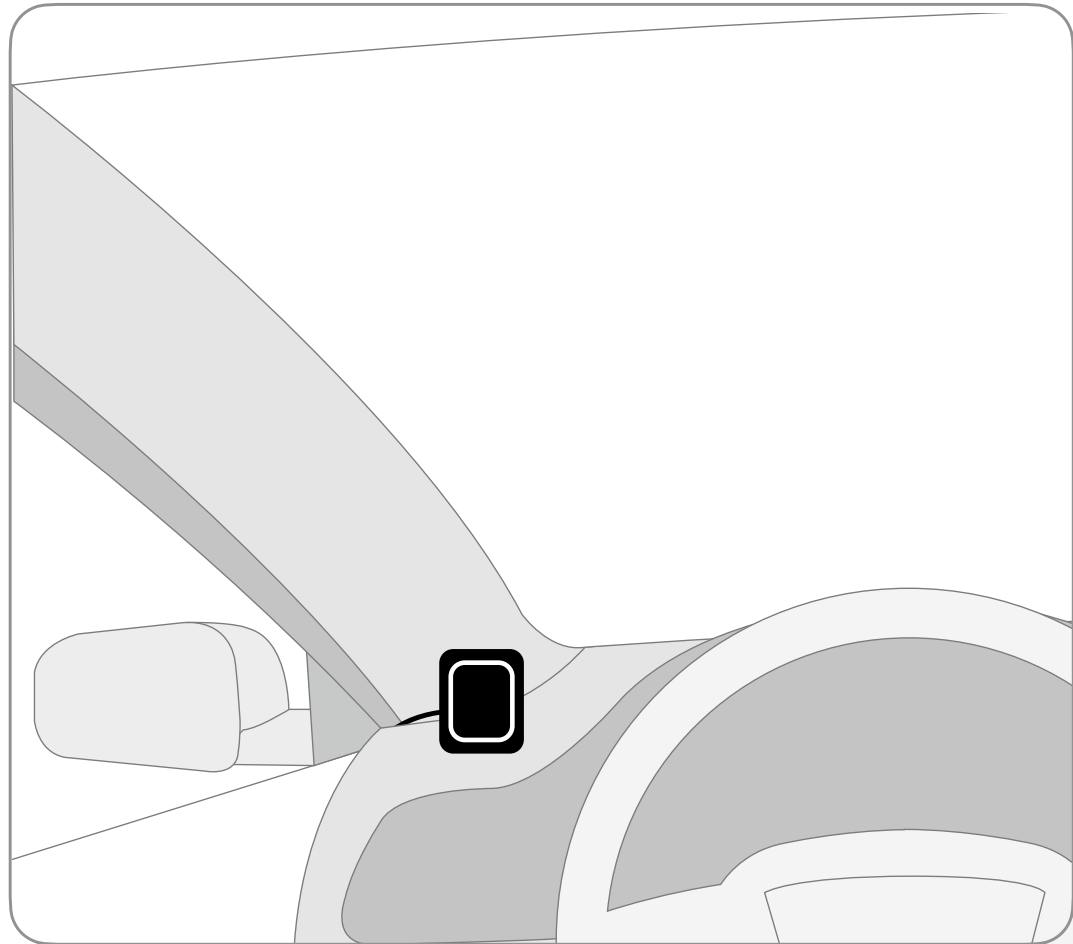

For a cleaner installation, run V-Display cable behind dashboard.

## OBD-II connection

Plug the OBD-II Cable connection into the vehicles OEM OBD-II Port which is normally located under the steering column on the driver side of the vehicle.

A splitter cable (optional) can also be used to hide the cabling behind the dashboard for a more covert type of installation.

**After installation has been completed, follow the steps in Titan User Manual to calibrate your FleetCam Pro setup.**

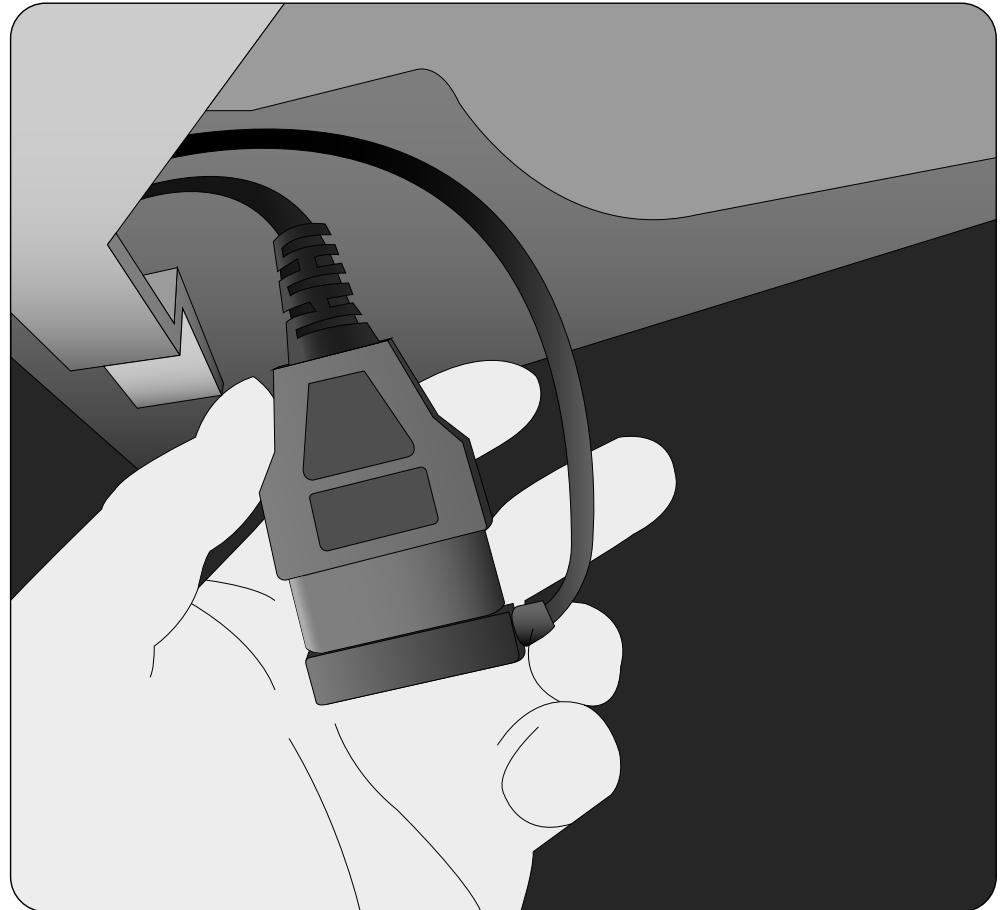

# JBUS Installation

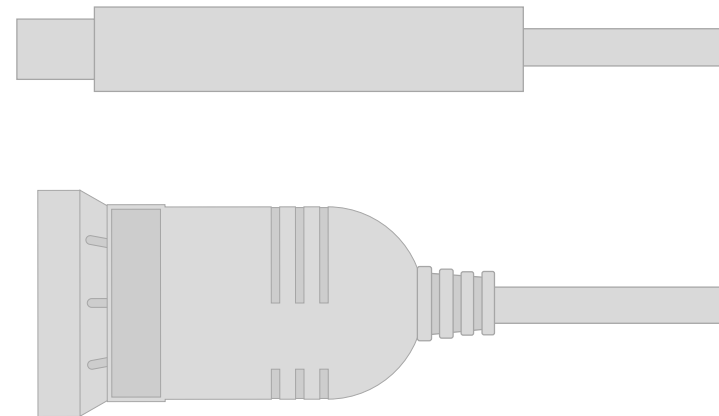

# JBUS installation diagram

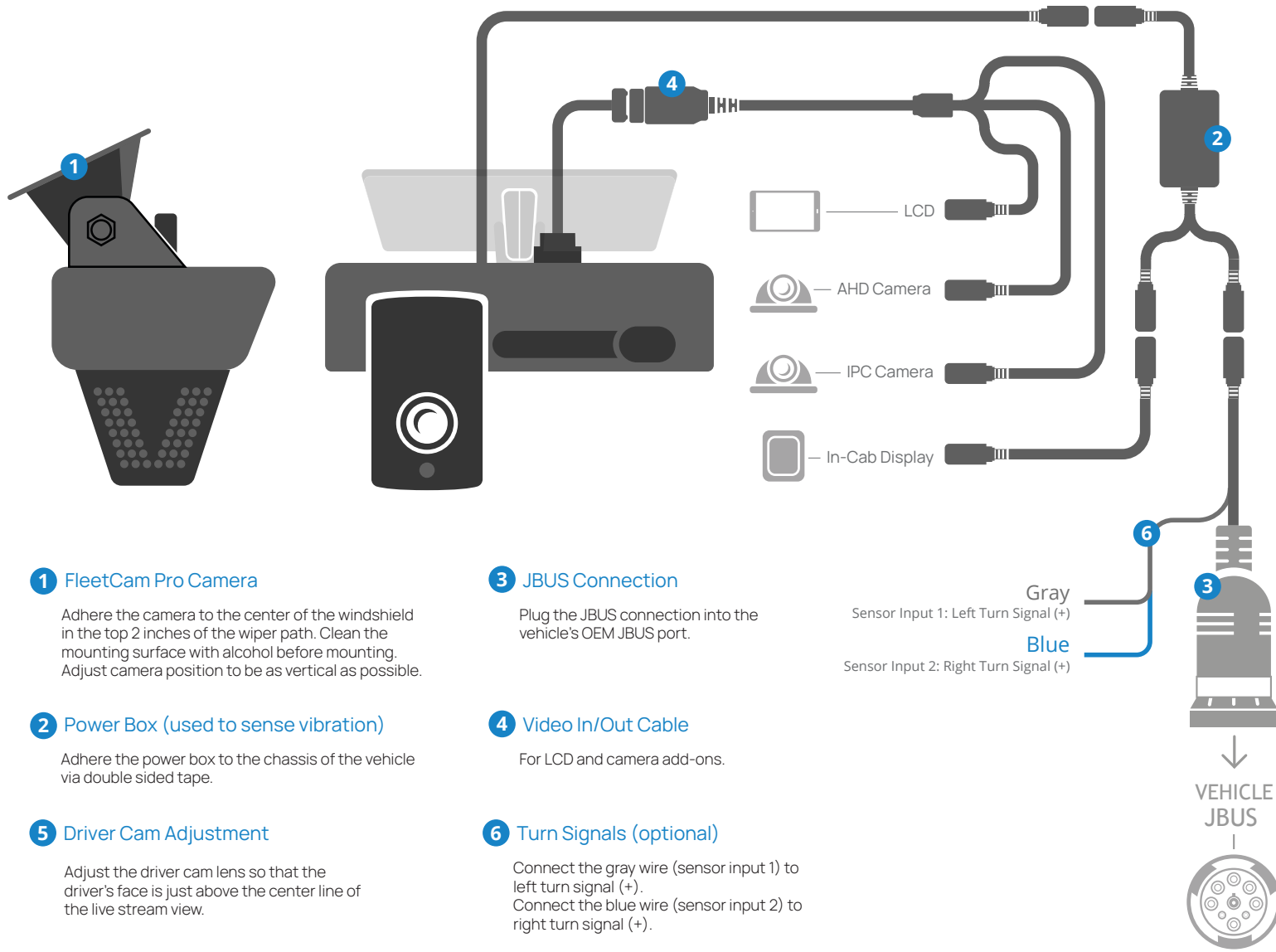

## 1 FleetCam Pro Camera

Adhere the camera to the center of the windshield in the top 2 inches of the wiper path. Clean the mounting surface with alcohol before mounting. Adjust camera position to be as vertical as possible.

## 2 Power Box (used to sense vibration)

Adhere the power box to the chassis of the vehicle via double sided tape.

## 5 Driver Cam Adjustment

Adjust the driver cam lens so that the driver's face is just above the center line of the live stream view.

## 3 JBUS Connection

Plug the JBUS connection into the vehicle's OEM JBUS port.

## 4 Video In/Out Cable

For LCD and camera add-ons.

## 6 Turn Signals (optional)

Connect the gray wire (sensor input 1) to left turn signal (+).  
Connect the blue wire (sensor input 2) to right turn signal (+).

Gray  
Sensor Input 1: Left Turn Signal (+)  
Blue  
Sensor Input 2: Right Turn Signal (+)

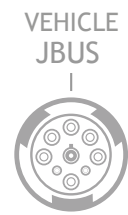

# Dash Cam mounting (JBUS)

- Desired installation location is the center of the windshield in the top 2 inches of the wiper path. (see figure 1 for reference).
- If the center of the windshield is an obstruction to the driver's line of vision the FC Pro can be offset towards the passenger side of the windshield (see figure 2 for reference). **Maximum offset measurement allowed is 4 inches (10.16cm).**
- If camera is not installed in the center of the windshield, the offset measurements must be entered during the calibration process (see FleetCam Pro Titan User Guide).
- Clean the mounting surface with rubbing alcohol before adhering the mounting bracket to windshield.
- Adhere mounting bracket by pressing bracket firmly on the windshield (Up indication on mounting bracket must point towards the ceiling).
- Secure the FleetCam Pro Camera to the mounting bracket w/ provided Phillips screw.
- Adjust camera position to be as vertical as possible.
- Run cabling underneath headliner and behind A-Pillar panel down towards behind the drivers side of the dashboard.

Refer to Page 8 for Power Box Installation & Page 9 for V-Display Installation (optional)

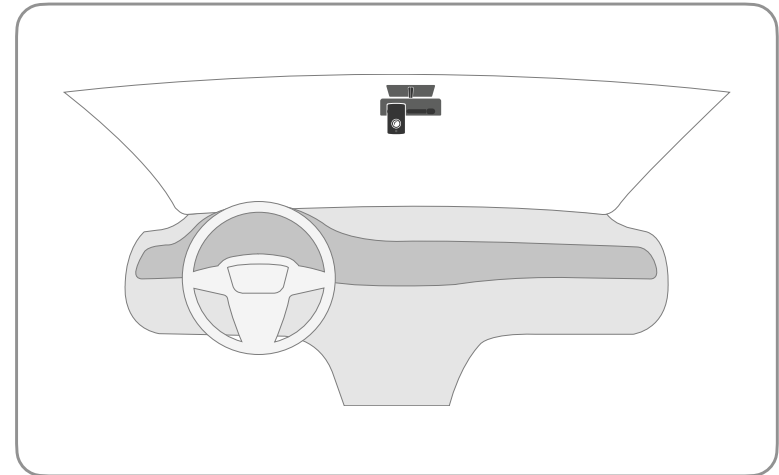

Fig. 1 Center Mount  
(recommended)

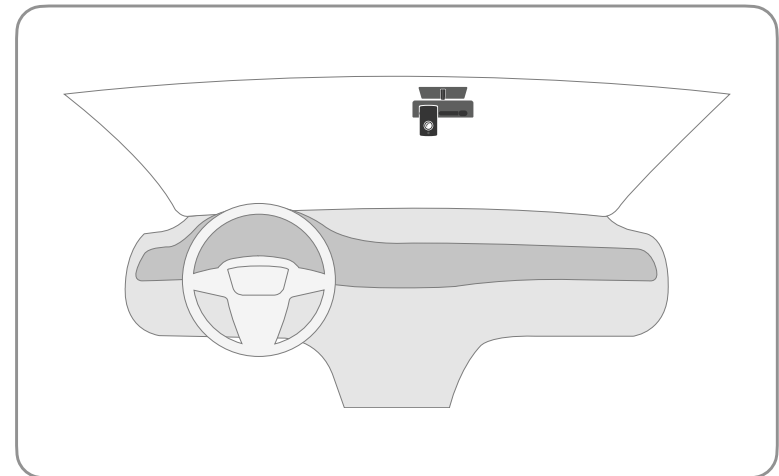

Fig. 2 Offset mount  
(Should be no more than 4 inches.)

# JBUS power connection

Plug the JBUS Cable connection into the vehicles OEM JBUS Port which is normally located under the steering column on the driver side of the vehicle.

A splitter cable (optional) can also be used to hide the cabling behind the dashboard for a more covert type of installation.

**After installation has been completed, follow the steps in Titan User Manual to calibrate your FleetCam Pro setup.**



# Hardwired Installation

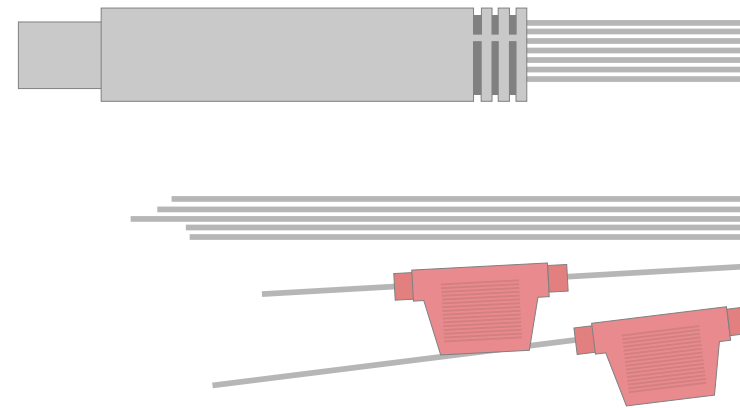

# Hardwired installation diagram

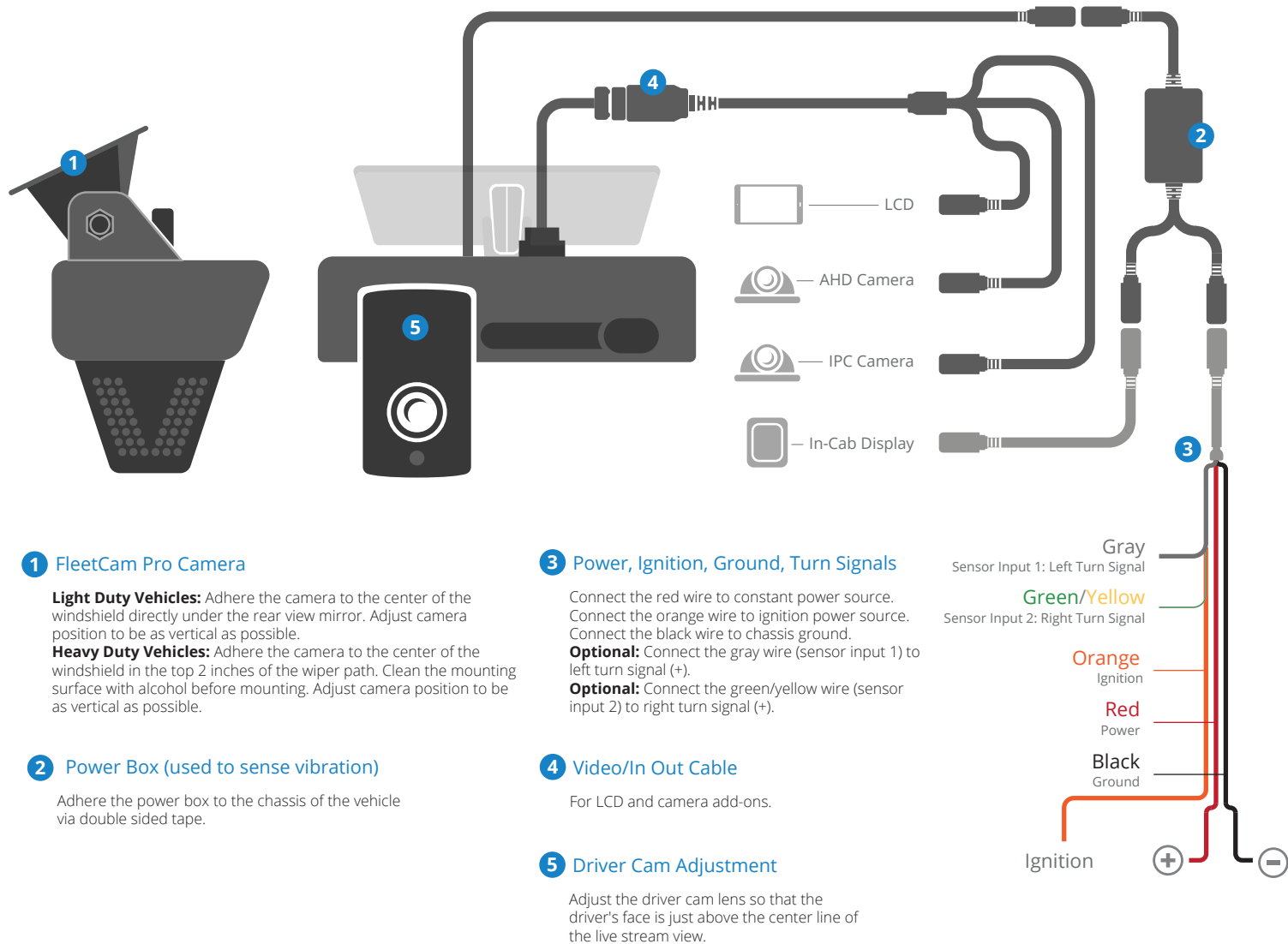



# Recommended tools & supplies

for Hardwire & Multi-Cam Installations

## Tools

Cordless Drill

Drill bit kit

Unibit

1/4" Ratchet

1/4" Socket set (Recommended sizes: 5mm to 17mm)

Screwdrivers (Phillips & Flathead)

Allen key set

Torx key set

Panel removal kit

Wire strippers/crimpers/cutters

DC Multi-Meter

Razor knife

Tape measurer

## Supplies

Zip-ties

Electrical tape

Heat shrink butt connectors

Heat shrink ring terminals

Fuse holders w/ fuses

Add-A-Fuse adapters

Grommets

Split loom

P-Clamps

RTV silicone

Rubbing alcohol

Butane torch

Rags

# Approved hardwired termination methods

Heat Shrink Butt Connectors

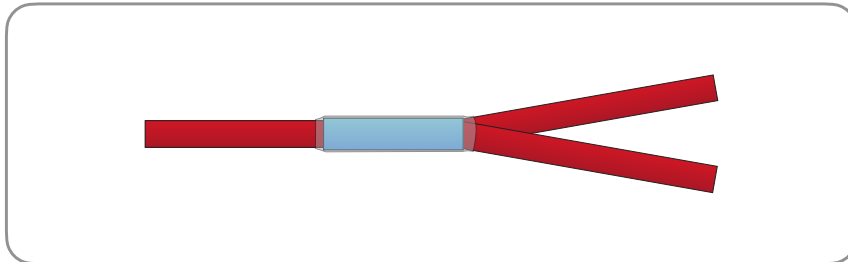

Add-A-Fuse Adapters

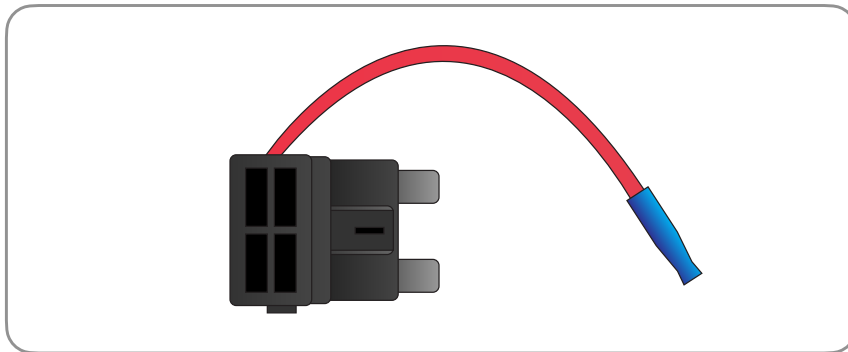

Soldering

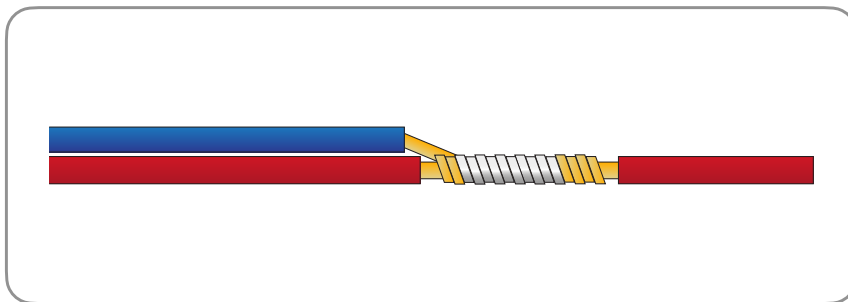

Poke & Wrap

1. Strip back **one inch** of the insulation on the vehicle wire.

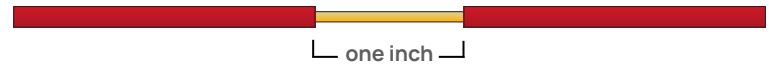

2. Separate the strands of the vehicle wire to create a hole.



3. Insert the wire from the remote starter/bypass through the hole.

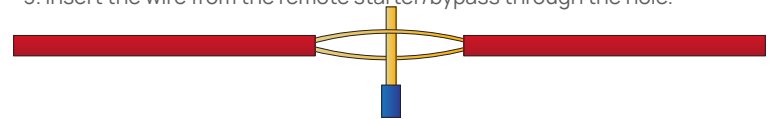

4. Wrap the wire around one side, then the other, and finally itself.



5. Lay the starter wire along side the vehicle wire.



6. Tape connection, and wire tie remote start/ bypass and vehicle wires together.



# Prohibited hardwired termination methods

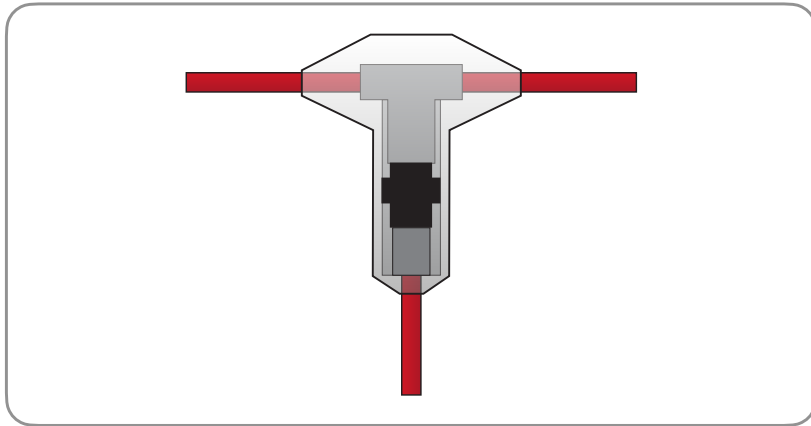

T-Tap Connectors (poor connection)

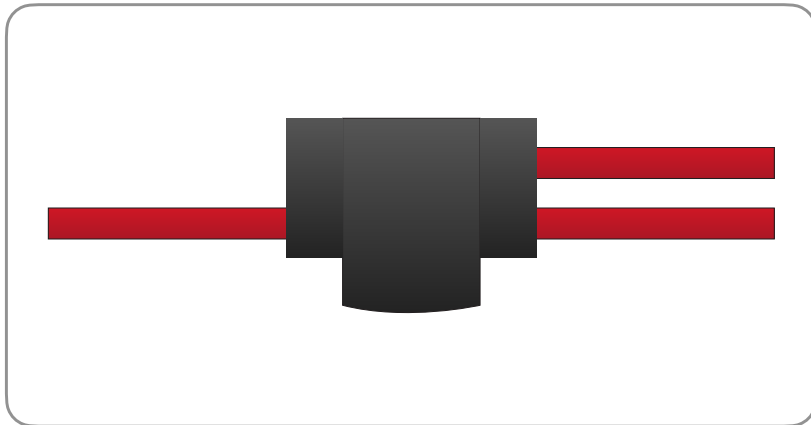

Scotch Lock Connectors (poor connection)



Non-Sealing Butt Connectors (allows for moisture and corrosion)

# FleetCam Pro with FCP Hub

# FleetCam Pro w/ Hub OBD-II installation diagram

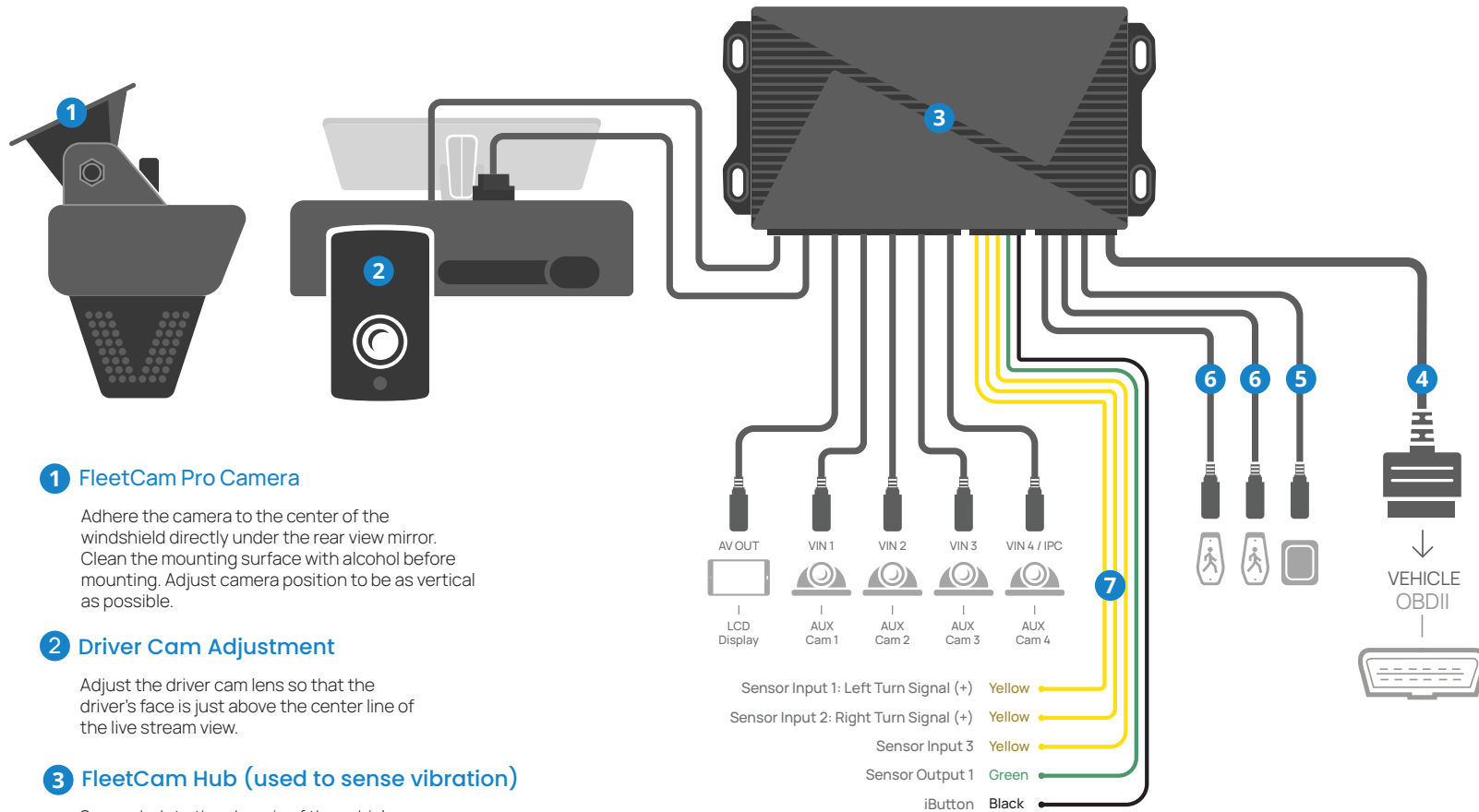

## 1 FleetCam Pro Camera

Adhere the camera to the center of the windshield directly under the rear view mirror. Clean the mounting surface with alcohol before mounting. Adjust camera position to be as vertical as possible.

## 2 Driver Cam Adjustment

Adjust the driver cam lens so that the driver's face is just above the center line of the live stream view.

## 3 FleetCam Hub (used to sense vibration)

Secure hub to the chassis of the vehicle.

## 4 OBD-II Connection

Plug the OBDII connection into the vehicle's OEM OBDII port.

## 5 V-Display

Adhere the V-Display to the top of the dashboard in a location easily viewable to the driver. Clean surface with alcohol before adhering.

## 6 Pedestrian Alert

Install pedestrian alert module(s) on the exterior rear side of the vehicle.

## 7 Turn Signals

Connect sensor input 1 to left turn signal.  
Connect sensor input 2 to right turn signal.

# FleetCam Pro w/ Hub JBUS installation diagram

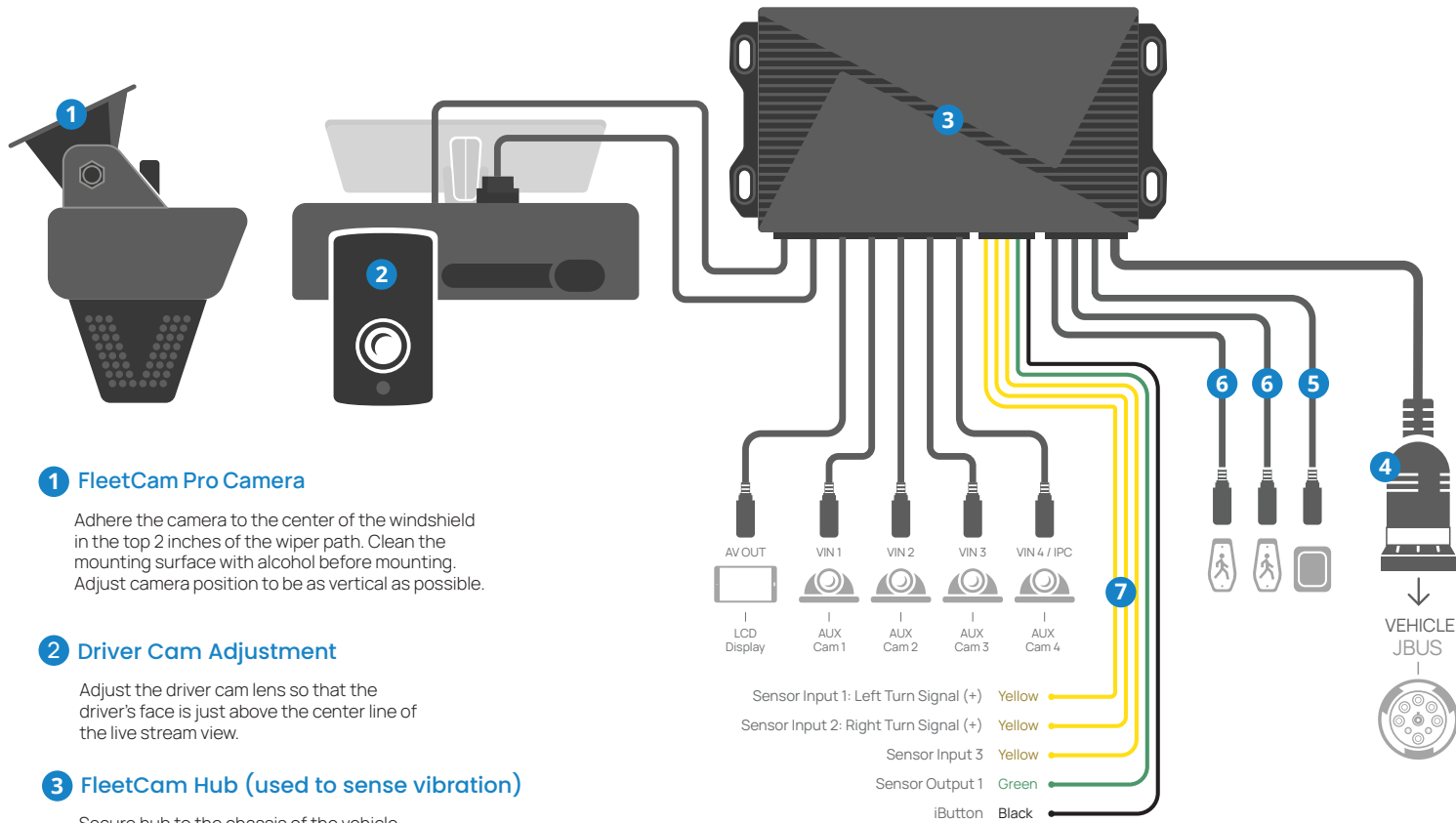

# FleetCam Pro w/ Hub hardwire installation diagram

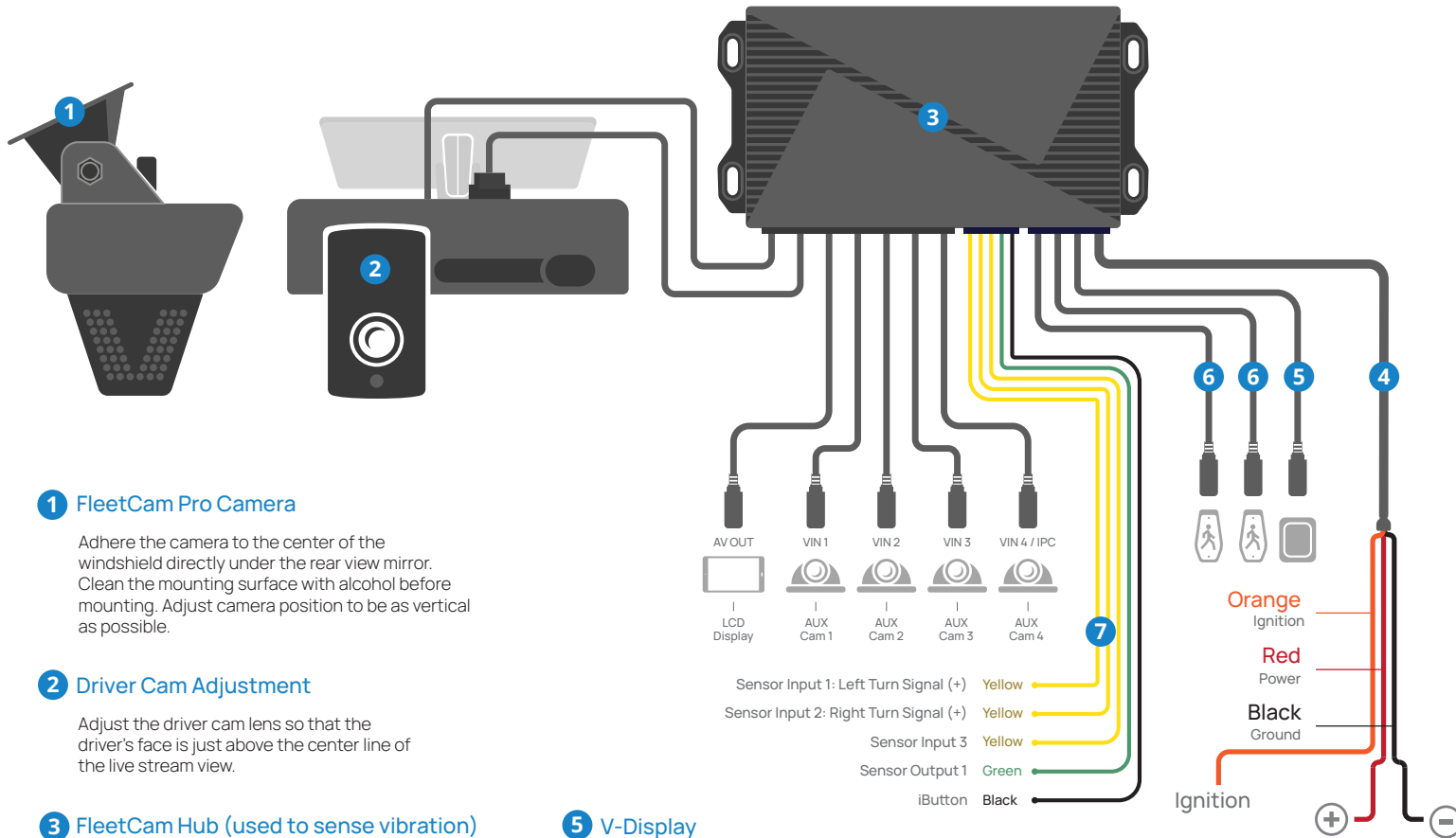

## 1 FleetCam Pro Camera

Adhere the camera to the center of the windshield directly under the rear view mirror. Clean the mounting surface with alcohol before mounting. Adjust camera position to be as vertical as possible.

## 2 Driver Cam Adjustment

Adjust the driver cam lens so that the driver's face is just above the center line of the live stream view.

## 3 FleetCam Hub (used to sense vibration)

Secure hub to the chassis of the vehicle.

## 4 Power, Ignition, Ground

Connect the red wire to constant power source. Connect the orange wire to ignition power source. Connect the black wire to chassis ground.

## 5 V-Display

Adhere the V-Display to the top of the dashboard in a location easily viewable to the driver. Clean surface with alcohol before adhering.

## 6 Pedestrian Alert

Install pedestrian alert module(s) on the exterior rear side of the vehicle.

## 7 Lane Departure (optional)

Connect Sensor Input 1 to left turn signal (+)  
Connect Sensor Input 2 to right turn signal (+)

# FC Pro LCD installation diagram

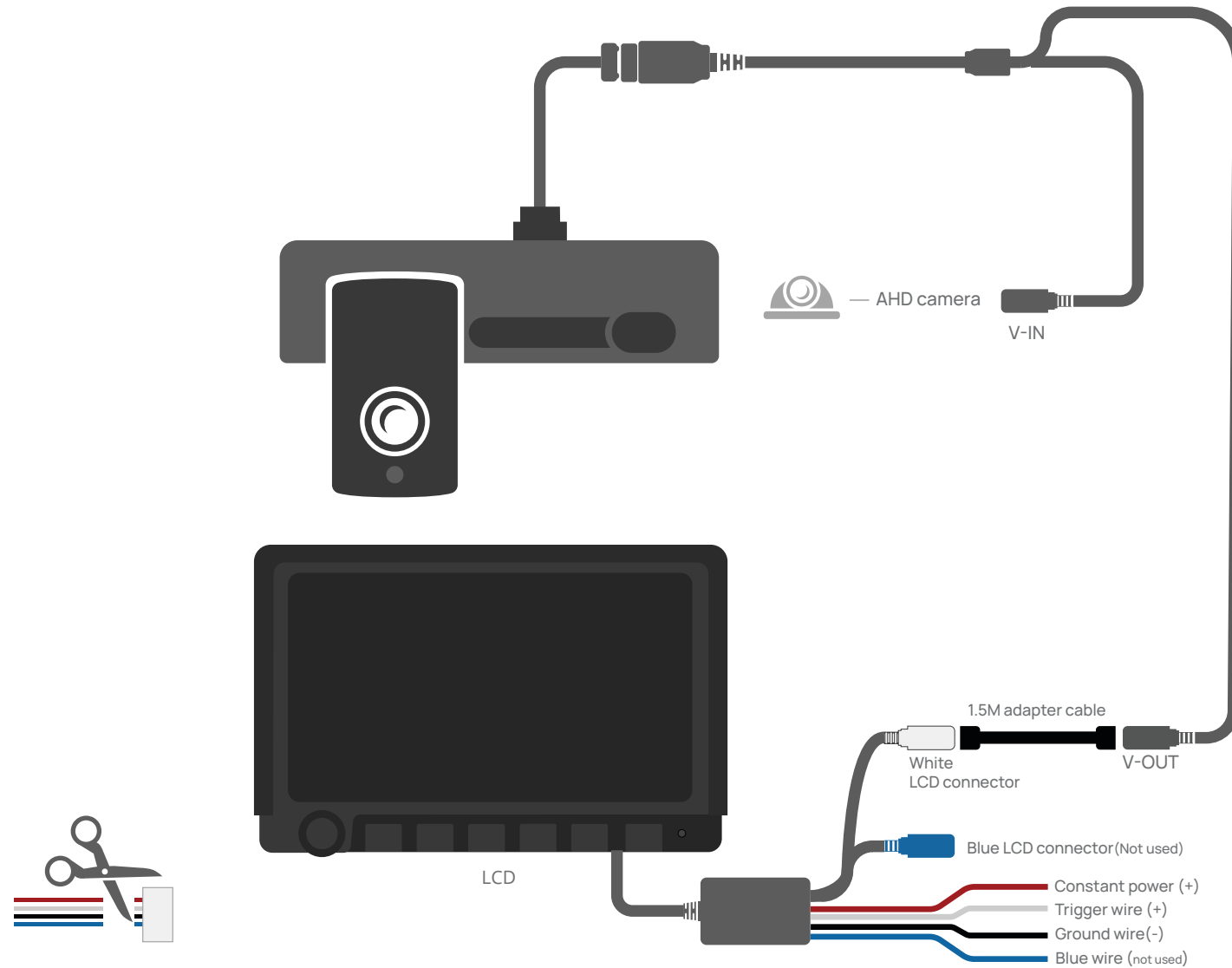







\* Existing connector **must be cut off** of harness

\*\* Trigger wire is commonly used for ignition (+) or reverse (+)



# LED indicators



LED	Name	Description	Icon
1	Power	Green On after unit is powered on	
2	Alarm	Default Off Flashes Red 3 times after any event is triggered	
3	GPS	Default Off – GPS Normal Red On – GPS acquiring signal	
4	Server Connectivity	Default Off – Connected Red On – Trying to connect to the server	
5	Wi-Fi	Default Off – WiFi either in client mode or not being used RED ON – Wi-Fi in AP mode or configuration mode	
6	External Cam	OFF – External camera is recording (if present). RED ON – External camera is malfunctioning	

If any assistance is needed, please reach out to FTS Support Desk for assistance:

866-221-1862 ext. 2/ [support@ftsgps.com](mailto:support@ftsgps.com)

FleetCam, FORWARD THINKING, the F Logo, and FTS are trademarks of Forward Thinking Systems LLC registered in the U.S. and other countries and regions.

Titan is a service mark of Forward Thinking Systems LLC.

© 2022 Forward Thinking Systems. All rights reserved.