



FleetCam Pro with 360 Hub

OBD-II

ID/FCPRO/FC360/2025/2/O

1 FleetCam Pro Camera

Light Duty Vehicles:

Adhere the camera to the center of the windshield directly under the rear view mirror. Clean the mounting surface with alcohol before mounting. Adjust camera position to be as vertical as possible.

Heavy Duty Vehicles:

Adhere the camera to the center of the windshield in the top 2 inches of the wiper path. Clean the mounting surface with alcohol before mounting. Adjust camera position to be as vertical as possible.

2 Power Box (used to sense vibration)

Adhere the power box to the chassis of the vehicle via double-sided tape.

3 OBD-II

Plug OBD-II connection into the vehicle's OEM OBD-II port. Gray wire (sensor input 1) to left turn signal (+). Green/Yellow wire (sensor input 2) to right turn signal (+). Blue wire (sensor input 3) to reverse trigger (+).

4 Video In/Out Cable

LCD & 360 Hub

V-IN port connects to AHD port of 360 Hub.
IPC port connects to IPC port of 360 Hub.
V-OUT port connects to male AHD port of LCD.

5 V-Display (optional)

Adhere the V-Display to the top of the dashboard in a location easily viewable to the driver. Clean surface with alcohol before adhering.

6 FC 360 Hub

Red wire to constant power source (+).
Orange wire to ignition power source (+).
Black wire to chassis ground (-).
Secure hub behind vehicle's dashboard.

7 LCD

Red wire to constant power source (+).
Orange wire to ignition power source (+).
Black wire to chassis ground (-).
Yellow male AHD port connects to the V-Out port of the V-I/O cable. Use the 3m adapter cable as an extension between the two connectors.

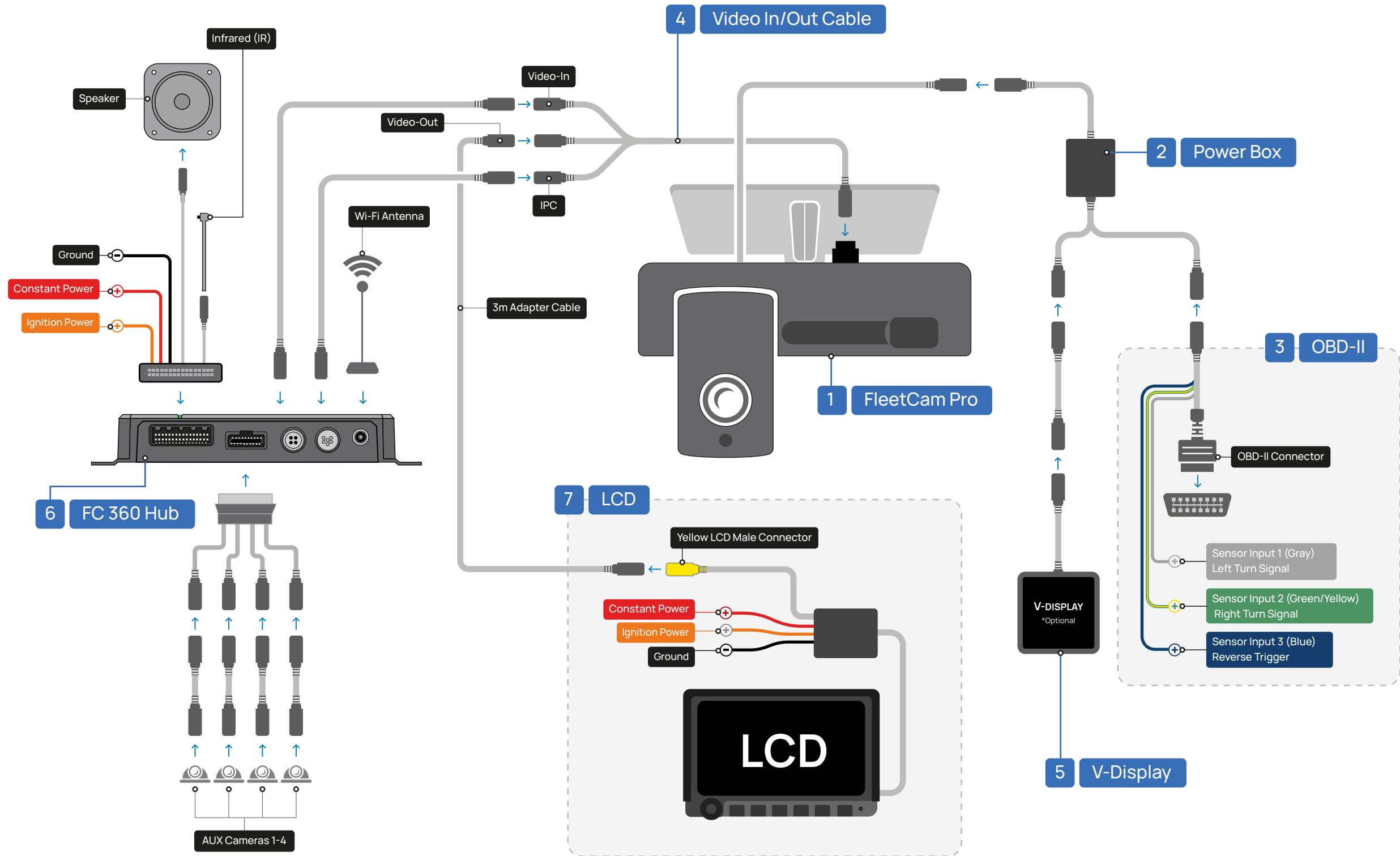

1 FleetCam Pro Camera

Light Duty Vehicles:

Adhere the camera to the center of the windshield directly under the rear view mirror. Clean the mounting surface with alcohol before mounting. Adjust camera position to be as vertical as possible.

Heavy Duty Vehicles:

Adhere the camera to the center of the windshield in the top 2 inches of the wiper path. Clean the mounting surface with alcohol before mounting. Adjust camera position to be as vertical as possible.

2 Power Box (used to sense vibration)

Adhere the power box to the chassis of the vehicle via double-sided tape.

3 Hardwired

- Red** wire to **constant power source (+)**.
- Orange** wire to **ignition power source(+)**.
- Black** wire to **chassis ground (-)**.
- Gray** wire (sensor input 1) to **left turn signal (+)**.
- Green/yellow** wire (sensor input 2) to **right turn signal (+)**.
- Blue** wire (sensor input 3) to **reverse trigger (+)**.

4 Video In/Out Cable

LCD & 360 Hub

V-IN port connects to **AHD** port of 360 Hub.
IPC port connects to **IPC** port of 360 Hub.
V-OUT port connects to male **AHD** port of LCD.

5 V-Display (optional)

Adhere the V-Display to the top of the dashboard in a location easily viewable to the driver. Clean surface with alcohol before adhering.

6 FC 360 Hub

Red wire to **constant power source (+)**.
Orange wire to **ignition power source (+)**.
Black wire to **chassis ground (-)**.
 Secure hub behind vehicle's dashboard.

7 LCD

Red wire to **constant power source (+)**.
Orange wire to **ignition power source (+)**.
Black wire to **chassis ground (-)**.
Yellow male **AHD** port connects to the **V-Out** port of the **V-I/O** cable. Use the 3m adapter cable as an extension between the two connectors.

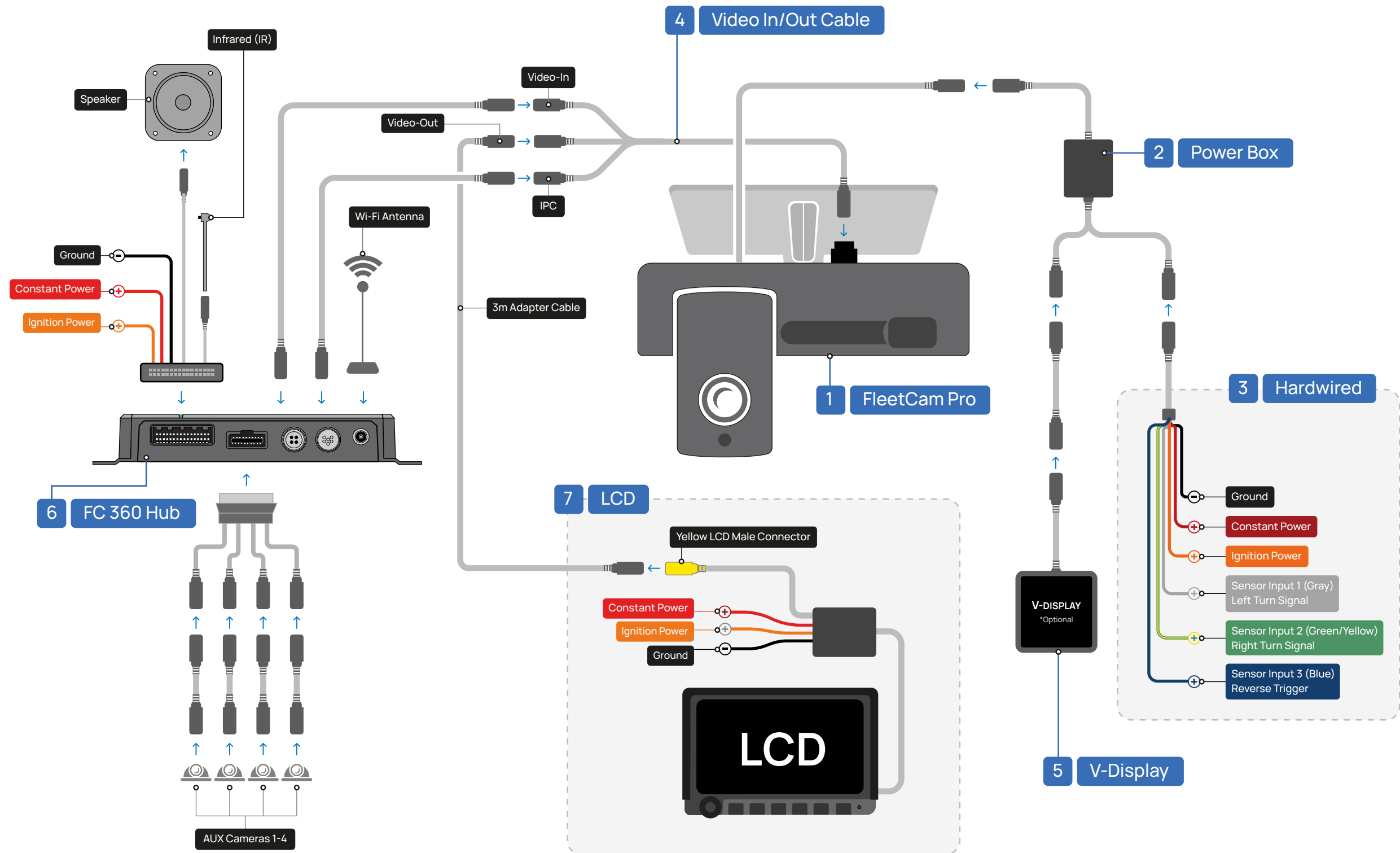



FleetCam Pro with 360 Hub

JBUS

ID/FCPRO/FC360/2025/2/J

1 FleetCam Pro Camera

Light Duty Vehicles:

Adhere the camera to the center of the windshield directly under the rear view mirror. Clean the mounting surface with alcohol before mounting. Adjust camera position to be as vertical as possible.

Heavy Duty Vehicles:

Adhere the camera to the center of the windshield in the top 2 inches of the wiper path. Clean the mounting surface with alcohol before mounting. Adjust camera position to be as vertical as possible.

2 Power Box (used to sense vibration)

Adhere the power box to the chassis of the vehicle via double-sided tape.

3 JBUS

Plug JBUS connection into the vehicle's OEM JBUS port. Gray wire (sensor input 1) to left turn signal (+). Green/Yellow wire (sensor input 2) to right turn signal (+). Blue wire (sensor input 3) to reverse trigger (+).

4 Video In/Out Cable

LCD & 360 Hub

V-IN port connects to AHD port of 360 Hub.
IPC port connects to IPC port of 360 Hub.
V-OUT port connects to male AHD port of LCD.

5 V-Display (optional)

Adhere the V-Display to the top of the dashboard in a location easily viewable to the driver. Clean surface with alcohol before adhering.

6 FC 360 Hub

Red wire to constant power source (+).
Orange wire to ignition power source (+).
Black wire to chassis ground (-).
Secure hub behind vehicle's dashboard.

7 LCD

Red wire to constant power source (+).
Orange wire to ignition power source (+).
Black wire to chassis ground (-).
Yellow male AHD port connects to the V-Out port of the V-I/O cable. Use the 3m adapter cable as an extension between the two connectors.

