



FleetCam Pro Hardwired

with FleetCam Pro Hub

1 FleetCam Pro Camera

- Light Duty Vehicles:
- **Adhere the camera to the center** of the windshield directly under the rear view mirror.
 - **Clean the mounting surface** with rubbing alcohol before mounting.
- Heavy Duty Vehicles:
- **Adhere the camera to the center** of the windshield in the top 2 inches of the wiper path.
 - **Clean the mounting surface** with rubbing alcohol before mounting.

- If the center of the windshield is an obstruction to the driver's line of vision the FleetCam Pro can be offset towards the passenger side of the windshield.
- **Maximum offset** measurement allowed is **4 inches**.
- **Adjust camera** position to be **as vertical as possible**.

2 FleetCam Pro Hub

- Secure hub to the chassis of the vehicle.

3 Power Harness

- Connect the **Red** wire to **constant power source(+)**.
- Connect the **Orange** wire to **ignition power source(+)**.
- Connect the **Black** wire to **chassis ground(-)**.

4 V-Display (Optional)

- **Adhere the V-Display** to the top of the dashboard in a location easily viewable to the driver.
- **Clean surface** with rubbing alcohol before adhering.

5 Pedestrian Alert (Optional)

Install pedestrian alert module(s) on the exterior rear side of the vehicle.

6 Lane Departure (Optional)

- Connect Sensor Input 1 to left turn signal (+)
- Connect Sensor Input 2 to right turn signal (+)

7 LCD

- Connect the **Red** wire to **constant power source(+)**.
- Connect the **Orange** wire to **ignition power source(+)**.
- Connect the **Black** wire to **chassis ground(-)**.

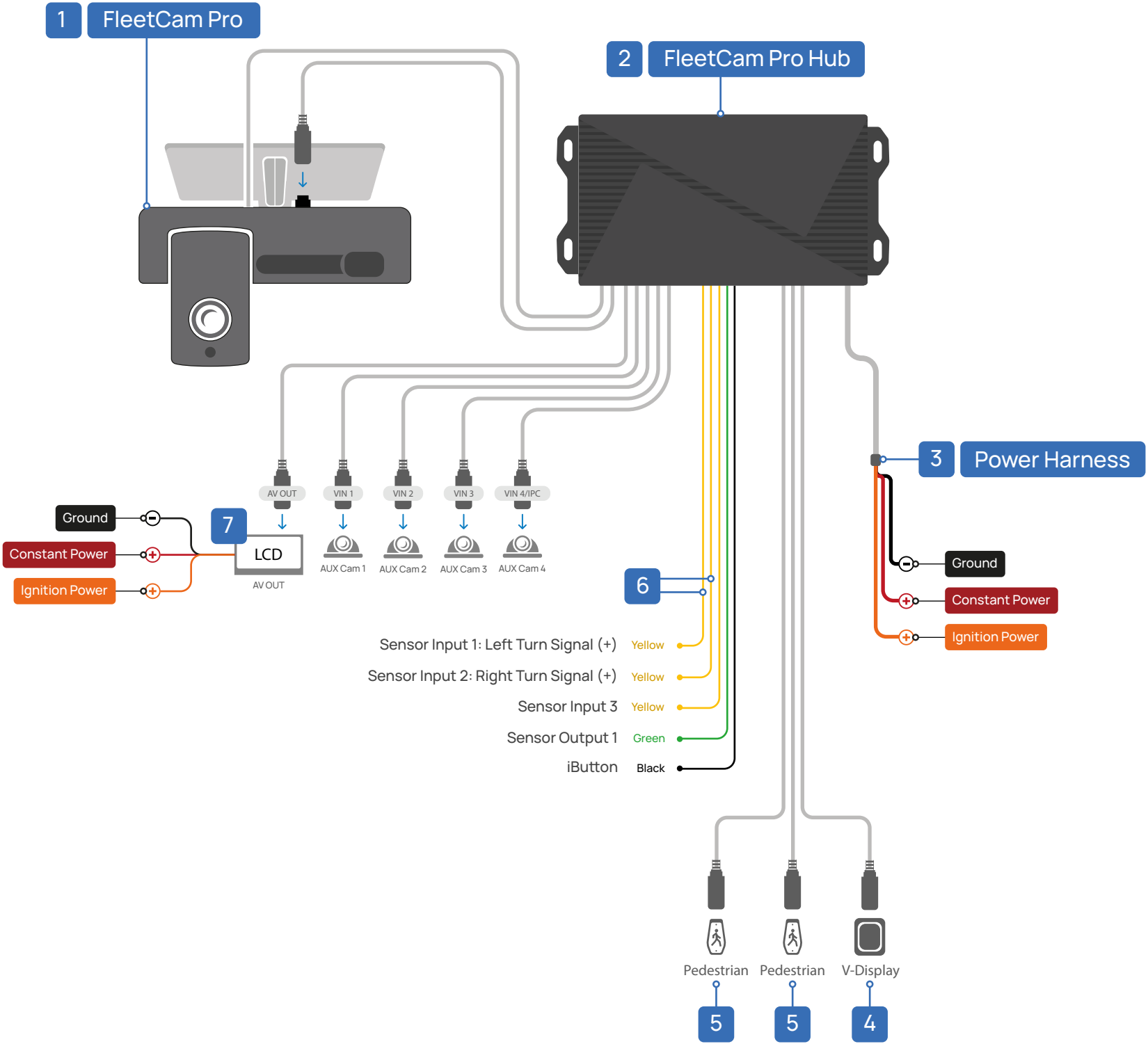



1 FleetCam Pro Camera

Light Duty Vehicles:

- Adhere the camera to the center of the windshield directly under the rear view mirror.
- Clean the mounting surface with rubbing alcohol before mounting.

Heavy Duty Vehicles:

- Adhere the camera to the center of the windshield in the top 2 inches of the wiper path.
- Clean the mounting surface with rubbing alcohol before mounting.

- If the center of the windshield is an obstruction to the driver's line of vision the FleetCam Pro can be offset towards the passenger side of the windshield.
- Maximum offset measurement allowed is 4 inches.
- Adjust camera position to be as vertical as possible.

2 FleetCam Pro Hub

- Secure hub to the chassis of the vehicle.

3 OBD-II

Plug the OBDII connection into the vehicle's OEM OBDII port.

4 V-Display (Optional)

- Adhere the V-Display to the top of the dashboard in a location easily viewable to the driver.
- Clean surface with alcohol before adhering.

5 Pedestrian Alert (Optional)

Install pedestrian alert module(s) on the exterior rear side of the vehicle.

6 Lane Departure (Optional)

- Connect Sensor Input 1 to left turn signal (+)
- Connect Sensor Input 2 to right turn signal (+)

7 LCD

- Connect the Red wire to constant power source(+).
- Connect the Orange wire to ignition power source(+).
- Connect the Black wire to chassis ground(-).

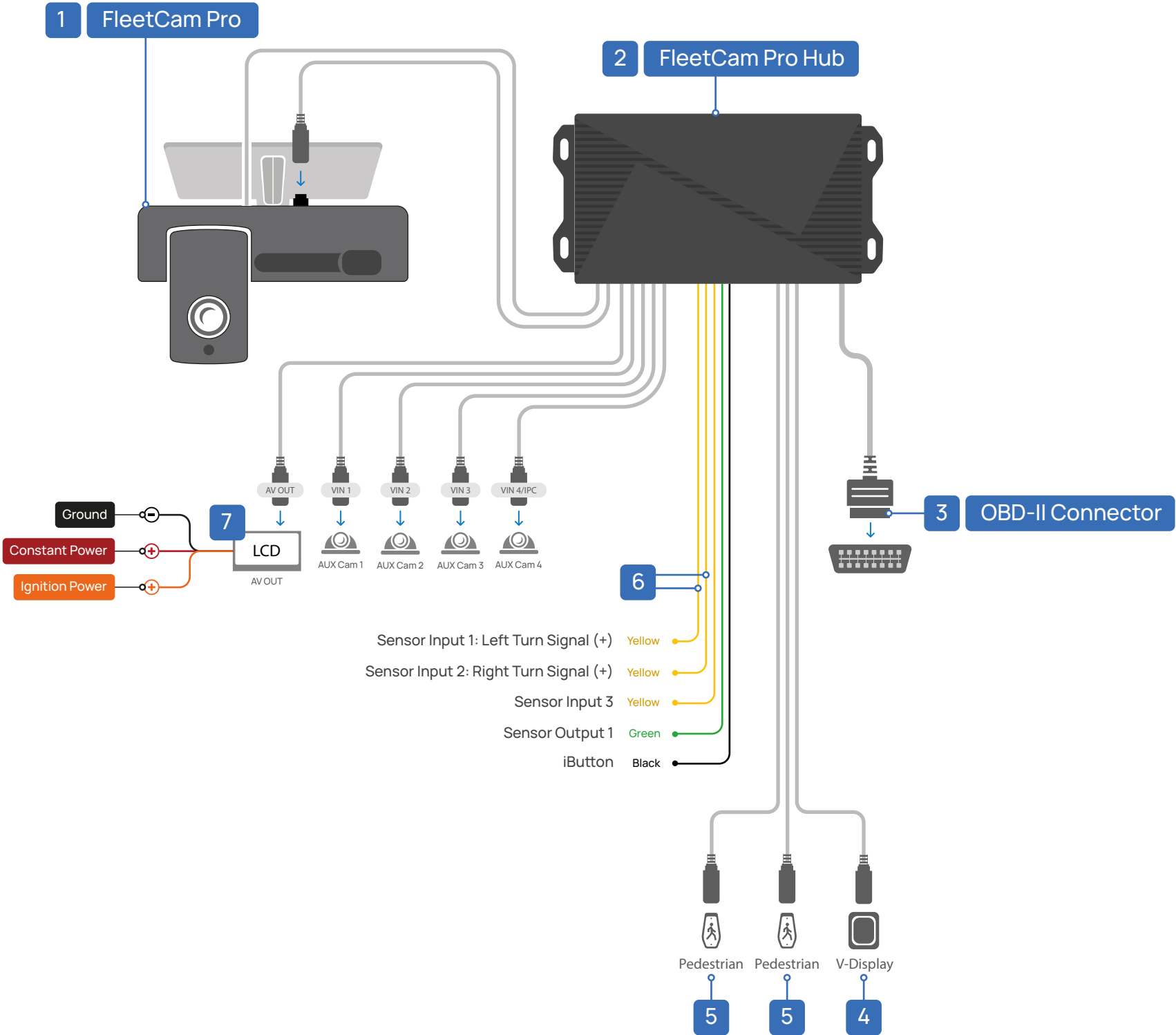



1 FleetCam Pro Camera

Light Duty Vehicles:

- **Adhere the camera to the center** of the windshield directly under the rear view mirror.
- **Clean the mounting surface** with rubbing alcohol before mounting.

Heavy Duty Vehicles:

- **Adhere the camera to the center** of the windshield in the top 2 inches of the wiper path.
- **Clean the mounting surface** with rubbing alcohol before mounting.

- If the center of the windshield is an obstruction to the driver's line of vision the FleetCam Pro can be offset towards the passenger side of the windshield.
- **Maximum offset** measurement allowed is **4 inches**.
- **Adjust camera** position to be **as vertical as possible**.

2 FleetCam Pro Hub

- Secure hub to the chassis of the vehicle.

3 JBUS

Plug the JBUS connection into the vehicle's OEM JBUS port.

4 V-Display (Optional)

- **Adhere the V-Display** to the top of the dashboard in a location easily viewable to the driver.
- **Clean surface** with rubbing alcohol before adhering.

5 Pedestrian Alert (Optional)

Install pedestrian alert module(s) on the exterior rear side of the vehicle.

6 Lane Departure (Optional)

- Connect Sensor Input 1 to left turn signal (+)
- Connect Sensor Input 2 to right turn signal (+)

7 LCD

- Connect the **Red** wire to **constant power source(+)**.
- Connect the **Orange** wire to **ignition power source(+)**.
- Connect the **Black** wire to **chassis ground(-)**.

